

# C.I.P.

## 25 Win. Super Short Mag.

Country of Origin: US

TAB. I

Date 06-05-16

Revision 11-05-25

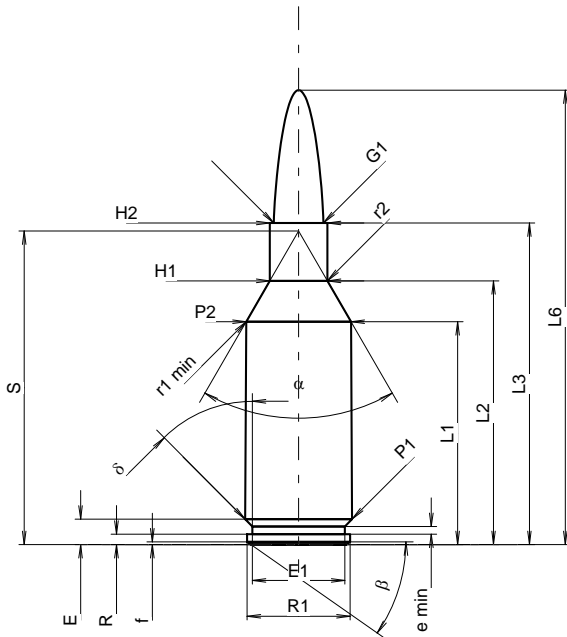

### CARTRIDGE MAXI

#### Lengths

L1 <sup>1)</sup>	=	29.40	-0.20
L2 <sup>1)</sup>	=	34.79	-0.20
L3 <sup>1)</sup>	=	42.42	
L4	=		
L5	=		
L6	=	59.94	

#### Case Head

R	=	1.37	
R1	=	13.59	
R3	=		
E	=	3.36	
E1	=	12.19	
e min	=	1.02	
delta	=	45°	
f	=	0.35	
beta	=	35°	

#### Powder Chamber

P1	=	14.12	
P2 <sup>1)</sup> *	=	13.83	-0.20

#### Junction Cone

alpha *	=	60°	
S *	=	41.36	
r1 min	=	1.27	
r2	=	3.30	

#### Collar

H1 *	=	7.60	
H2 <sup>1)</sup>	=	7.60	

#### Projectile

G1 <sup>1)</sup> *	=	6.54	
G2	=		
F	=		
L3+G <sup>1)</sup>	=	51.76	

#### Pressures (Energies)

#### Method Transducer

Pmax	=	4400 bar	
PK	=	5060 bar	
PE	=	5500 bar	
M	=	17.50	
EE	=	3500 Joule	

#### Miscellaneous Dimensions

Fe <sup>1)3)</sup>	=	0.10	
delta L	=	0.08	

### CHAMBER MINI

#### Lengths

L1	=	29.29	
L2	=	34.67	
L3 <sup>1)</sup>	=	42.68	

#### Breech

R	=		
R1	=	14.19	
R2	=		
R3	=		
r	=		

#### Powder Chamber

E	=	3.36	
P1 <sup>1)</sup>	=	14.15	
P2 *	=	13.86	

#### Junction Cone

alpha <sup>1)</sup> *	=	60°	
S *	=	41.30	
r1 max	=	1.27	
r2	=	3.81	

#### Collar

H1 *	=	7.65	
H2 <sup>1)</sup>	=	7.62	

#### Commencement of Rifling

G1 <sup>1)</sup> *	=	6.63	
G	=	9.34	
alpha l	=	90°	
h	=	0.50	
s *	=	4.67	
i <sup>1)</sup>	=	1°43'	
w	=		

#### Barrel

F <sup>1)</sup> *	=	6.35	
Z <sup>1)</sup>	=	6.53	

#### Grooves

b	=	2.44	
N	=	6	
u	=	254.00	
Q	=	33.02	mm <sup>2</sup>

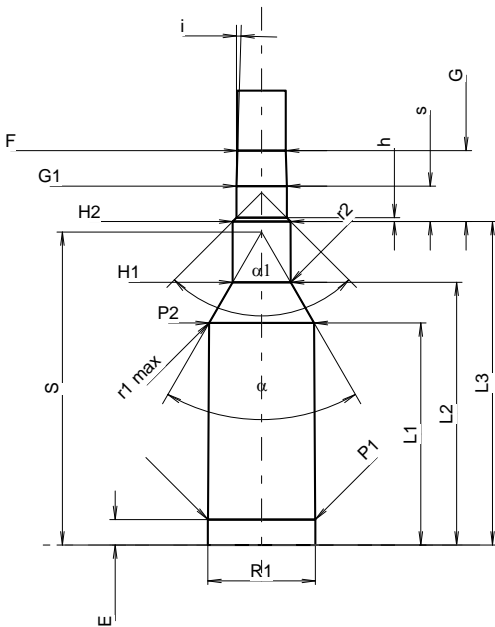

Scale 1.0:1

Dimensions in << mm >>  
Dimensions and Tolerances for Proof Barrels  
see Appendix CR 1.

Notes: 1) Check for safety reasons  
3) Headspace on Shoulder  
\* Basic dimensions